

DH Series

7-50W LED Downlight

Fixed anti-glare COB led downlight

BESUN DH series fixed anti-glare COB led downlight, the lowest UGR can be 16, you can choose different color of glare shield according to environment and customer needs, available color: luxury gold, champagne gold, silver mirror, black mirror, etc.

DH Series;
Patented designs (6 patents)

Support almost all the famous light source;
Perfectly compatible with the same light fixture, same size, but different light source.

Completely free solder assembling;
Replace any accessories perfectly without Soldering Tools

Perfect secondary optical design;
Beautiful light spot for wide/medium/small beam angle.

IP33

Greatly enhance the cold lumens;
135lm/W under CRI>90 & 3000K.

Non-flicker Driver;
Support Triac dim; 1-10V dim; Dali dim; Wifi dim, etc.

5 years warranty

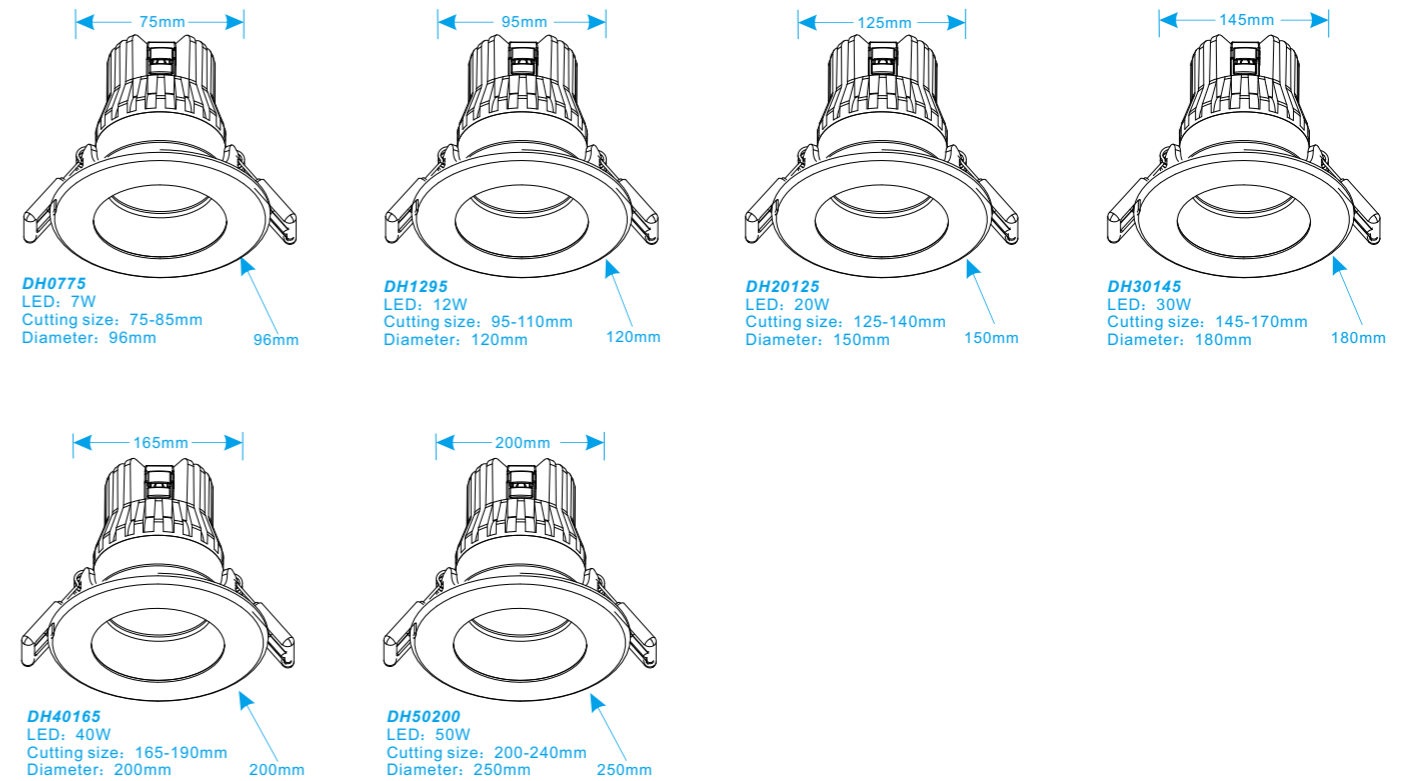

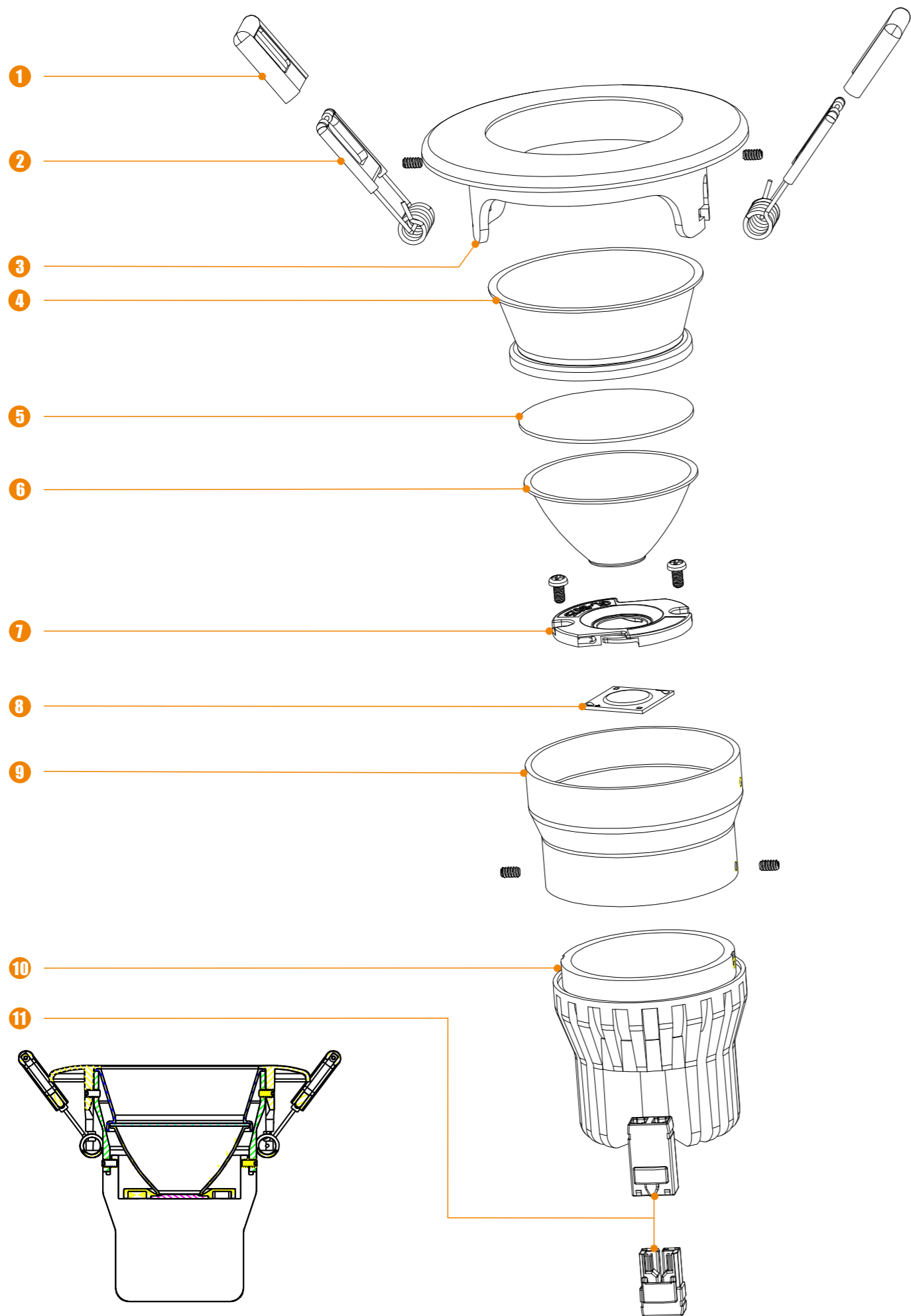

LED DOWNLIGHT DH

1 Silicone spring cover to protect hands and paint



2 High-performance springs has passed salt spray test, corrosion resistance test, and anti-decay, ensure no deformation in 10 years.



3 Various color housing optional: white, silver, black, golden, etc.



4 Optical anti-glare shield, lower the UGR effectively

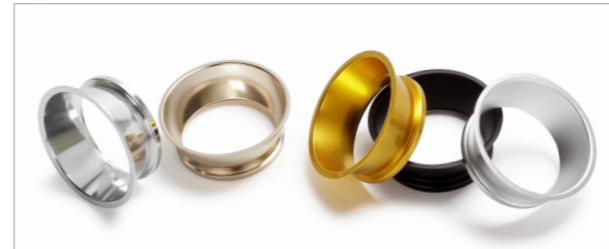

5 Full tempered glass, even if broken, it will not endanger your safety. Optional glass: clear glass, frosted glass, middle-frosted glass.

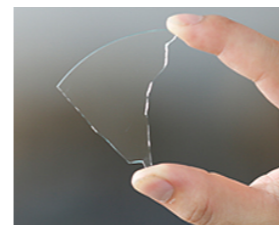

6 Pure aluminum reflective cup, anodizing, anti-corrosiveness and anti-aging, which is different from electroplating plastic cup. Optional beam angle : 15°-110°

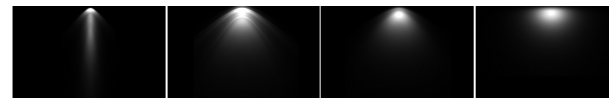

7 Free soldering LED connector (patented design)



8 Optional LED

BESUN(COB)

CREE(COB)

CITIZEN(COB)



SHARP(COB)

9 Black connecting ring

10 The passive radiator with superior heat dissipation under -40-55°C working environment. (L-80 temperature measuring point of light source is 25°C, 65°C and 85°C)

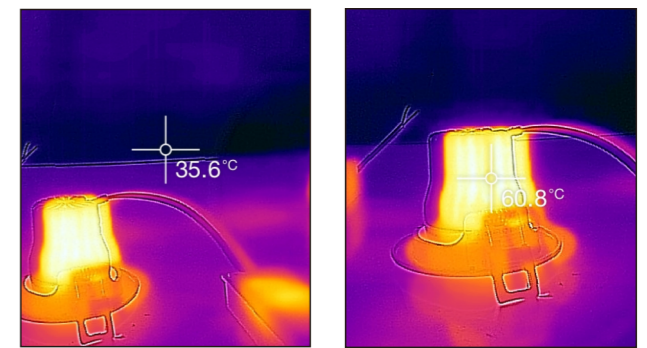

11 Recessed anti-pull-off connector (patented design)

Recessed connector design ensure the maximum installation space of the lamp, The connector deviate less than 1.5mm under 10r pull; the lamp and driver can be easily connected or replaced without soldering.



LED DOWNLIGHT DH

7W COB LED DOWNLIGHT



DH0775S



BESUN DH series fixed anti-glare COB led downlight, the lowest UGR can be 16, you can choose different color of glare shield according to environment and customer needs, available color: luxury gold, champagne gold, silver mirror, black mirror, etc.

- **Support almost all the famous light source;**
Perfectly compatible with the same light fixture, same size, but different light source.
- **Completely free solder assembling;**
Replace any accessories perfectly without Soldering Tools
- **Perfect secondary optical design;**
Beautiful light spot for wide/medium/small beam angle.
- **Physically waterproof and dustproof;**
The highest IP rating reaches IP33
- **Greatly enhance the cold lumens;**
136lm/W under CRI>90 & 3000K.
- **Non-flicker Driver;**
Support Triac dim; 1-10V dim; Dali dim; Wifi dim, etc.
- **5 years warranty**

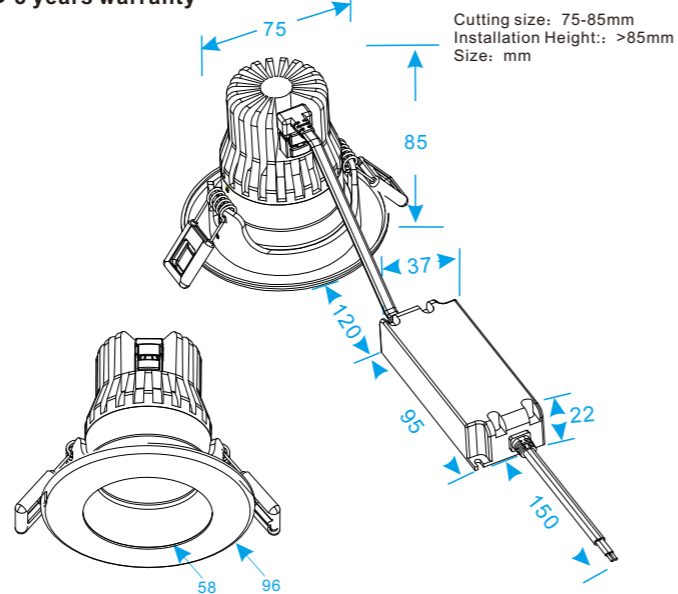

Application:
DH series downlights are widely used as indoor main illumination lighting in household, hotel, restaurant, shopping mall, bar, KTV, cabinet, office, meeting room, library, museum, exhibition etc...

● Standard ○ Optional — Unsupported “E” Economy type “S” Standard type

LED	BESUN	BESUN	CREE	CITIZEN	SHARP				
Brand	● B20151305(S) ○ B20151307(M)	B20151202(E)	● CXA1507	● 026-1202C1	GW6NGWJCSOC				
PCB	ceramic	ceramic	ceramic	aluminum	ceramic				
CRI	● 90 R9>50 ○ other	● 90 R9>50 ○ other	● 80 R9>0 ○ 90 R9>50	● 90 R9>50 ○ other	● 95 R9>90				
Power(W)	7	7	7	7	0.5-7				
Voltage(V)	36V	36V	34.6V	36V	36V				
Features	135lm/w	114lm/w	CREE	116lm/w	CCT Dimmable				
CCT;LM/W 27=2700K 35=3500K	CCT	LM/W	CCT	LM/W	CCT	LM/W	W		
	● 27	126	○ 27	105	● 27	120	● 20	69	1.5W
	● 30	135	● 30	114	● 30	120	● 25	80	3.3W
	● 40	144	● 40	122	○ 35	130	● 27	84	4.9w
	○ 50	148	○ 50	125	● 40	130	● 28	84	6.6w
	○ 60	150	○ 60	123	○ 50	130			
○ other	CRI>90	○ other	CRI>90	○ other	CRI>80				

LED chip quantity	● 13*5 ○ 13*7	12*2	12*2	12*2	12*2
Certificates	L-80	-	L-80	L-80	L-80
Current Rating(mA)	200				
SDCM	<4				

● Standard ○ Optional — Unsupported “E” Economy type “S” Standard type

Driver	NO-DIM	DIM	Dali/Push-Dim	1-10V/Push-Dim	WiFi (intelligent)
Brand	● Lifud(S) ● 200-240VAC GIR010YS ○ 100-277VAC GIR007YA	● Eaglerise(S) ● 200-240VAC ELP009C0200LSD1	● Easeic ● 100-240VAC LND118	● Easeic ● 100-240VAC LNA118	● LTECH ● 12-48VDC WiFi104R R4-5A R4-CC T1 T2 T2M T3 T3M
	○ Eaglerise(E) ○ 200-240VAC EIP009C0200LSS	○ Eaglerise(E) ○ 200-240VAC EIP009C0200LSD1L			
DC Output	27-42V/200mA	27-42V/200mA	27-42V/180mA	27-42V/180mA	12-48V 1-1400mA
PF/PE	GIR010YS 0.95/83% GIR007YA 0.95/80% EIP009C0200LSS 0.5/84%	ELP009C0200LSD1 0.95/80% EIP009C0200LSD1L 0.95/80%	0.9/80%	0.9/80%	/
Flickering	GIR010YS NO GIR007YA yes EIP009C0200LSS NO	ELP009C0200LSD1 NO EIP009C0200LSD1L yes	yes	yes	/
Certificates	GIR10YS(A)	ELP009C0200LSD1	LND118	LNA118	/
	CE CB GS RCM SAA CCC	CE SAA			
	GIR007YA	-	CE CUL SAA	CE CUL SAA	CE ROHS FCC
	CE	-			
	EIP009C0200LSS	EIP009C0200LSD1L			
CE TUV BIS	TUV CE SAA				

● Standard ○ Optional The lamp working voltage with different light source is corresponds to the driver working voltage

Lamp	BESUN	BESUN	CREE	CITIZEN	SHARP										
Item No.	DH0775S	DH0775E	DH0775S	DH0775S	DH0775S										
Warranty	5 years	3 years	5 years	5 years	5 years										
System Consumption(W)	8.5	8.5	8.5	8.5	1-9										
Beam Angle	25°/38°/60°/90°	25°/38°/60°/90°	20°/38°	20°/38°	38°										
UGR	17-28	17-28	16-18	16-18	18										
Soldering technology	Free soldering	Free soldering	Free soldering	Free soldering	—										
Certificates	CE RoHS FCC V0 ERP LM-79	CE RoHS FCC V0	CE RoHS FCC V0 ERP LM-79	CE RoHS FCC V0 ERP LM-79	CE RoHS FCC V0 ERP LM-79										
Working environment	-40°-55°														
IP grade	IP33														
Color of Housing	● W OS OB OV														
optical data	.IES/.CIE/.CEN/.Tm14/.CIB/.LDT														
System lm/w 30=3000K 35=3500K	CCT	LM	60°	CCT	LM	60°	CCT	LM	38°	CCT	LM	38°	CCT	LM	W
	● 27	610	○ 27	520	● 27	590	● 27	570	● 20	60	1.8				
	● 30	630	● 30	550	● 30	610	● 30	580	● 25	180	4				
	● 40	690	● 40	610	○ 35	662	○ 35	590	● 27	310	6				
	○ 50	680	○ 50	610	● 40	670	● 40	600	● 28	450	9				
	○ 60	720	○ 60	610	○ 50	680									
○ other	CRI>90	○ other	CRI>90	○ other	CRI>80										

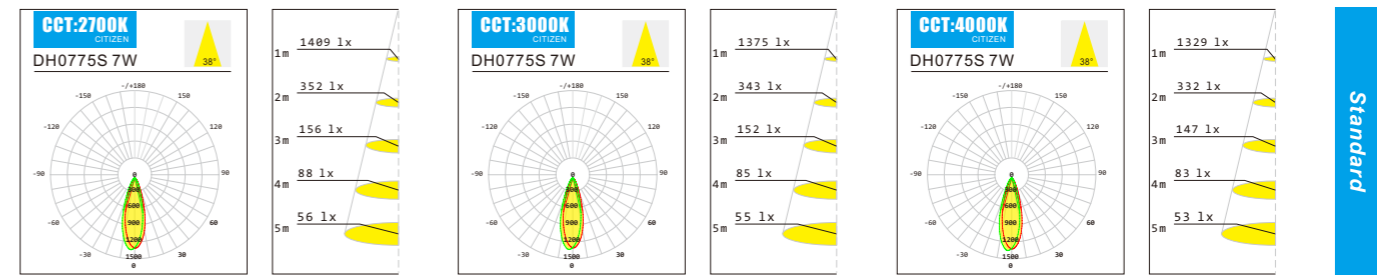
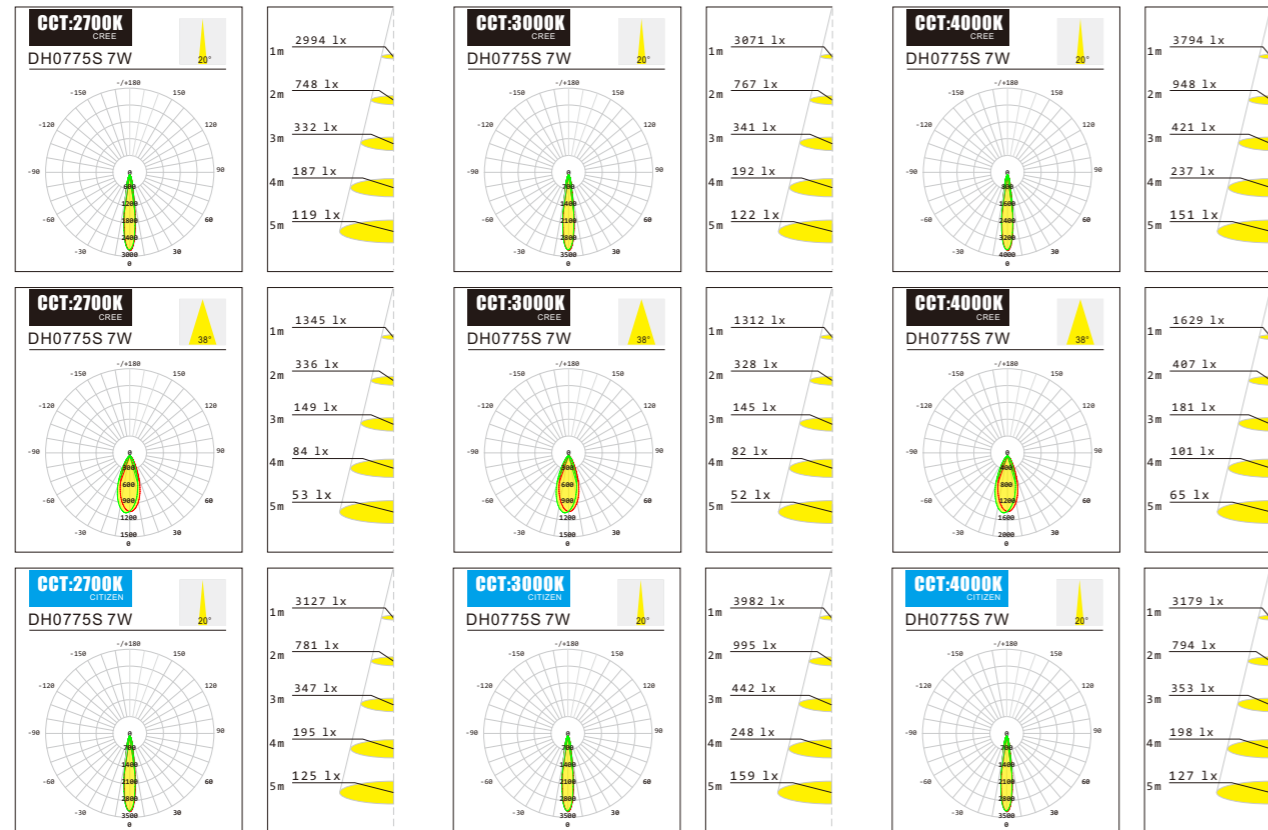
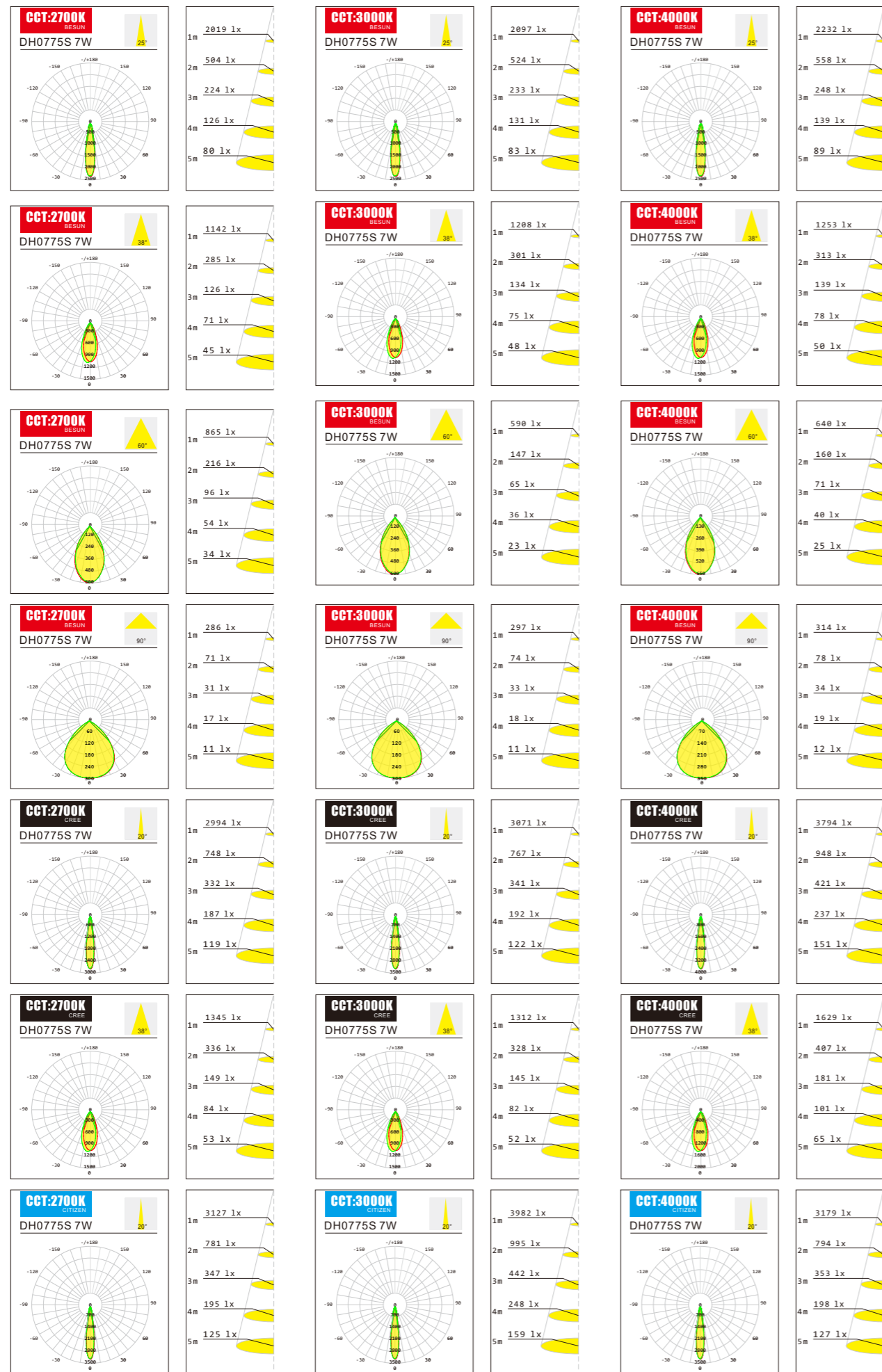

CCT/Parameters		BESUN DH0775S				BESUN DH0775E				CREE DH0775S		CITIZEN DH0775S	
2700K	Angle(°)	25.5°	37.5°	59.7°	89.4°	24.5°	37.3°	59.7°	89°	19.9°	36.8°	18.9°	35.5°
	RA	>90	>90	>90	>90	>90	>90	>90	>90	>80	>80	>90	>90
	LM	585	569	613	535	496	467	524	465	602	599	583	592
	UGR	17.5	19.6	26	28.8	18.8	19.4	25.8	28.3	16.4	18.6	16.2	17.4
3000K	Angle(°)	25°	37.5°	60°	89.2°	24.3°	37.5°	60°	89.6°	20°	36°	18.8°	35.5°
	RA	>90	>90	>90	>90	>90	>90	>90	>90	>80	>80	>90	>90
	LM	606	599	633	551	518	513	552	480	623	618	579	584
	UGR	18.2	19.5	26	28.5	18.8	19.8	25.9	28.8	17.2	18.8	16.8	18.8
4000K	Angle(°)	24.9°	37.9°	60.3°	89°	25.2°	37.9°	60.5°	89.4°	19.6°	35.5°	19°	36.1°
	RA	>90	>90	>90	>90	>90	>90	>90	>90	>80	>80	>90	>90
	LM	649	636	691	582	597	580	616	515	687	679	663	650
	UGR	18.7	19.7	26	29	18.4	19.9	26.1	28.5	17.5	18.9	17.6	17.5
5000K	Angle(°)	25.2°	38.3°	60.3°	89.8°	25.2°	38.3°	60.5°	89.4°	-	-	-	-
	RA	>90	>90	>90	>90	>90	>90	>90	>90	-	-	-	-
	LM	648	635	691	582	572	565	616	515	-	-	-	-
	UGR	18.7	19.7	26	29	18.4	19.9	26.1	28.8	-	-	-	-
6000K	Angle(°)	25°	37.7°	60.3°	89.9°	24.7°	38°	60.8°	90.2°	-	-	-	-
	RA	>90	>90	>90	>90	>90	>90	>90	>90	-	-	-	-
	LM	671	653	723	620	563	557	583	521	-	-	-	-
	UGR	18.8	20.1	26.1	28.9	18.9	20.2	27	29	-	-	-	-

Triac dimmer compatibility

Brand	Item No.	Item No.	picture
CLIPSAL	32E450UDM	220-240VAC 50Hz MAX:450W	
CLIPSAL	32E450ULM	220-240VAC 50Hz MAX:450W	
JUNG	225NV DE	220-240VAC 50Hz MAX:20-500W	
GIRA	226200/I01	220-240VAC 50Hz MAX:20-500W	
BERKER	2873	220-240VAC 50Hz MAX:20-500W	

2000K-3000K dimmable downlight graph(LED)

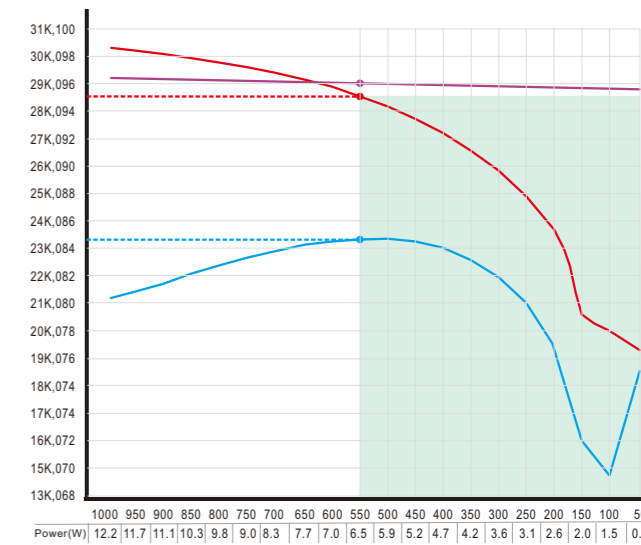

— CRI — CCT — light efficiency — DH0775S CCT dim range
 31K, 100=3100K, CRI 100 and 100LM/W
 1000=1000LM 950=950LM 900=900LM.....

12W COB LED DOWNLIGHT



DH1295S

NETWEIGHT	CUTTINGSIZE	PACKING	PACKING
0.5 Kg	95-105mm	12.5x12.5x13.5CM 1 pc	51.5x26.5x56.0CM 32 pcs



BESUN DH series fixed anti-glare COB led downlight, the lowest UGR can be 16, you can choose different color of glare shield according to environment and customer needs, available color: luxury gold, champagne gold, silver mirror, black mirror, etc.

- **Support almost all the famous light source;**
Perfectly compatible with the same light fixture, same size, but different light source.
- **Completely free solder assembling;**
Replace any accessories perfectly without Soldering Tools
- **Perfect secondary optical design;**
Beautiful light spot for wide/medium/small beam angle.
- **Physically waterproof and dustproof;**
The highest IP rating reaches IP33
- **Greatly enhance the cold lumens;**
131lm/W under CRI>90 & 3000K.
- **Non-flicker Driver;**
Support Triac dim; 1-10V dim; Dali dim; Wifi dim, etc.
- **5 years warranty**

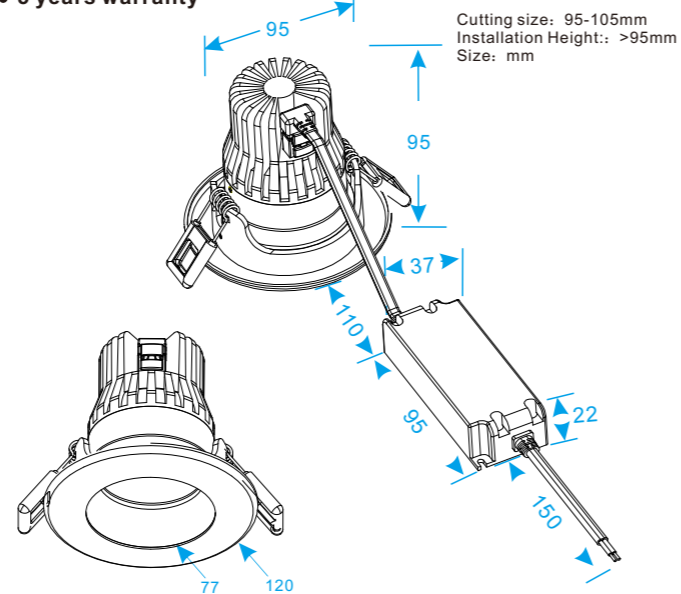

Application:
DH series downlights are widely used as indoor main illumination lighting in household, hotel, restaurant, shopping mall, bar, KTV, cabinet, office, meeting room, library, museum, exhibition etc...

● Standard ○ Optional — Unsupported “E” Economy type “S” Standard type

LED	BESUN	BESUN	CREE	CITIZEN	SHARP						
Brand	● B20151204(S)	● B20151204(E)	● CXA1512	● 026-1204C4	GW6NGWJCSOC						
PCB	ceramic	ceramic	ceramic	aluminum	ceramic						
CRI	● 90 R9>50 ○ other	● 90 R9>50 ○ other	● 80 R9>0 ○ 90 R9>50	● 90 R9>50 ○ other	● 95 R9>90						
Power(W)	12	12	12	12	0.5-12						
Voltage(V)	35V	35V	34.6V	35V	35V						
Features	131lm/w	114lm/w	CREE	117lm/w	CCT Dimmable						
CCT;LM/W 27=2700K 35=3500K	CCT	LM/W	CCT	LM/W	CCT	LM/W	CCT	LM/W	CCT	LM/W	W
	● 27	116	○ 27	112	● 27	123	● 27	115	● 20	69	1.5w
	● 30	131	● 30	114	● 30	134	● 30	117	● 25	80	3.3w
	● 40	136	● 40	124	○ 35	134	○ 35	117	● 27	84	4.9w
	○ 50	142	○ 50	126	● 40	134	● 40	139	● 30	80	12w
	○ 60	140	○ 60	122	○ 50	134	○ 50	134	○ other		
	○ other	CRI>90	○ other	CRI>90	○ other	CRI>80		CRI>90			CRI>95

LED chip quantity	12*4	12*4	12*3	12*4	12*2
Certificates	L-80	-	L-80	L-80	L-80
Current Rating(mA)	350				
SDCM	<4				

● Standard ○ Optional — Unsupported “E” Economy type “S” Standard type

Driver	NO-DIM	DIM	Dali/Push-Dim	1-10V/Push-Dim	WiFi (intelligent)
Brand	● Lifud(S) ● 200-240VAC GIR015YS ○ 100-277VAC GIR020Yk	● Eaglerise(S) ● 200-240VAC ELP012C0350LSD1	● Easeic ● 100-240VAC LND118	● Easeic ● 100-240VAC LNA118	● LTECH ● 12-48VDC WiFi104R R4-5A R4-CC T1 T2 T2M T3 T3M
	○ Lifud(E) ○ 200-240VAC GIR013YS0350H	○ Eaglerise(E) ○ 200-240VAC EIP012C0350LSD1L			
DC Output	27-42V/350mA	27-35V/350mA	27-42V/350mA	27-42V/350mA	12-48V 1-1400mA
PF/PE	GIR015YS 0.95/85% GIR020YK 0.95/85% GIR013YS0 350H 0.45/82%	ELP012C0350 LSD1 0.95/80% EIP012C0350 LSD1L 0.95/80%	0.9/80%	0.9/80%	/
Flickering	GIR015YS NO GIR020YK yes GIR013YS0 350H NO	ELP012C0350 LSD1 NO EIP012C0350 LSD1L yes	yes	yes	/
Certificates	GIR015YS(A)	ELP012C0350LSD1	LND118	LNA118	/
	CE CB GS RCM SAA CCC	CE SAA			
	GIR020YK	EIP012C0350LSD1L	CE CUL SAA	CE CUL SAA	CE ROHS FCC
	CE CB GS				
	GIR013YS0350H	TUV CE			

● Standard ○ Optional — Unsupported “E” Economy type “S” Standard type
The lamp working voltage with different light source is corresponds to the driver working voltage

Lamp	BESUN	BESUN	CREE	CITIZEN	SHARP										
Item No.	DH1295S	DH1295E	DH1295S	DH1295S	DH1295S										
Warranty	5 years	3 years	5 years	5 years	5 years										
System Consumption(W)	14	14	14	14	1-14										
Beam Angle	20°/38°/60°/95°	20°/38°/60°/95°	15°/38°	15°/38°	15°/38°										
UGR	14-28	14-28	12-16	12-16	12-16										
Soldering technology	Free soldering	Free soldering	Free soldering	Free soldering	—										
Certificates	CE RoHS FCC V0 ERP LM-79	CE RoHS FCC V0	CE RoHS FCC V0 ERP LM-79	CE RoHS FCC V0 ERP LM-79	CE RoHS FCC V0 ERP LM-79										
Working environment	-40°-55°														
IP grade	● IP33 ○ IP54														
Color of Housing	● W OS OB OV														
optical data	.IES/.CIE/.CEN/.Tm14/.CIB/.LDT														
System lm/w 30=3000K 35=3500K	CCT	LM	60°	CCT	LM	60°	CCT	LM	38°	CCT	LM	38°	CCT	LM	W
	● 27	911	○ 27	890	● 27	1150	● 27	963	● 20	80	1.8				
	● 30	1016	● 30	920	● 30	1231	● 30	1040	● 25	200	4				
	● 40	1120	● 40	1017	○ 35	1231	○ 35	1080	● 27	450	6				
	○ 50	1118	○ 50	1034	● 40	1231	● 40	1244	● 30	790	13.5				
	○ 60	1097	○ 60	973	○ 50	1240									
	○ other	CRI>90	○ other	CRI>90	○ other	CRI>80	CRI>90				CRI>95				

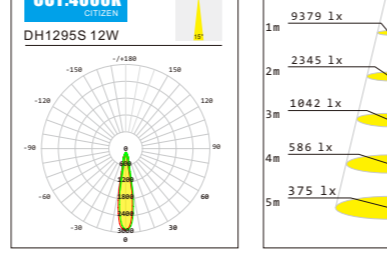
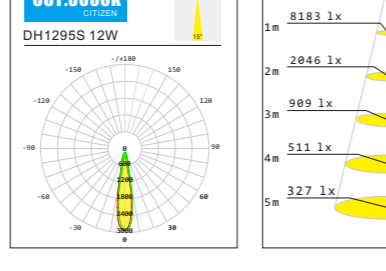
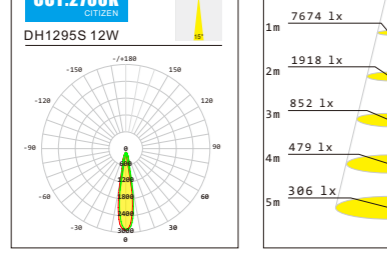
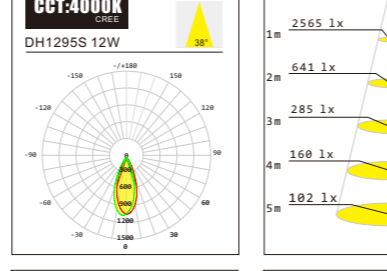
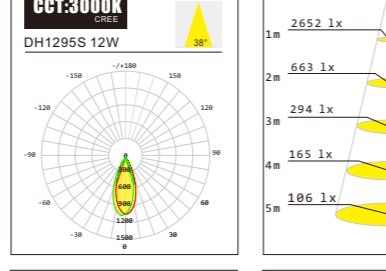
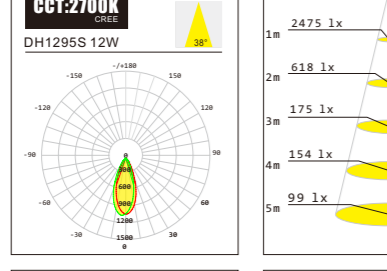
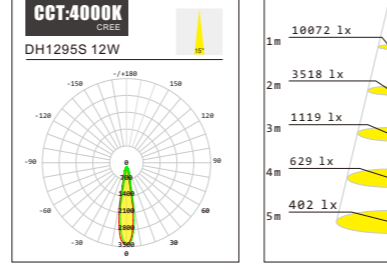
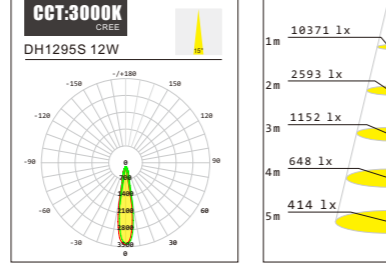
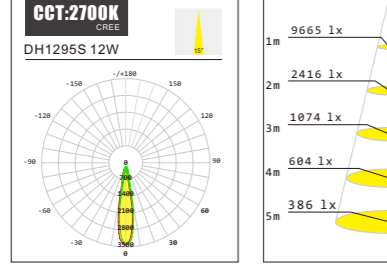
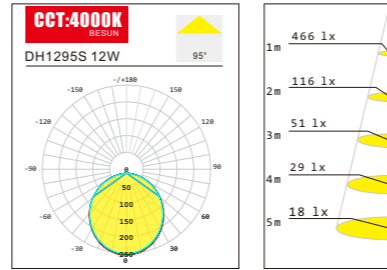
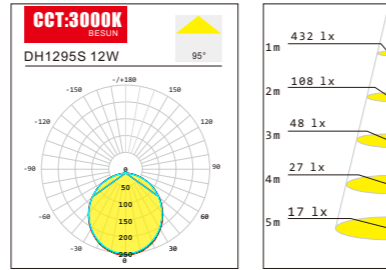
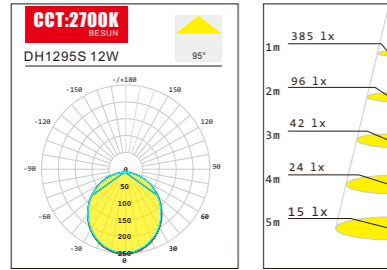
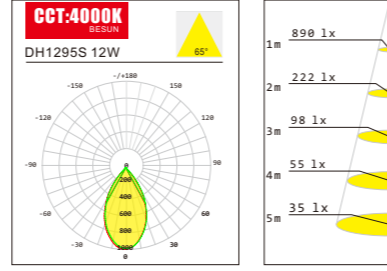
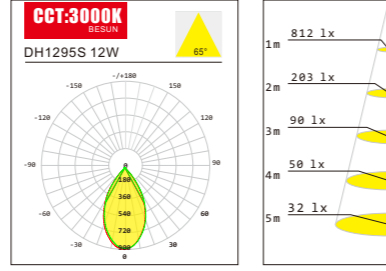
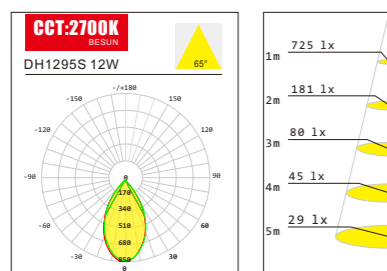
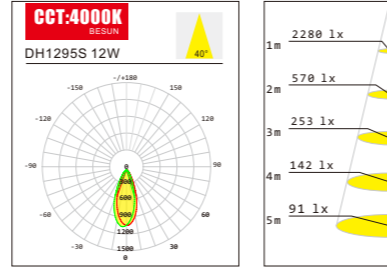
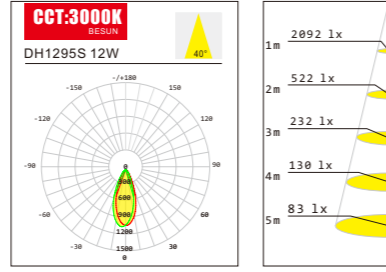
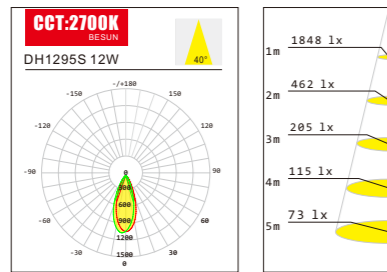
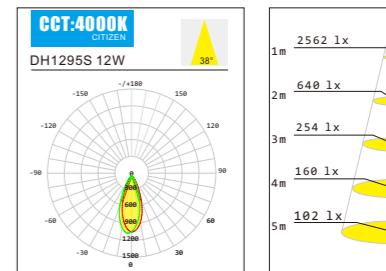
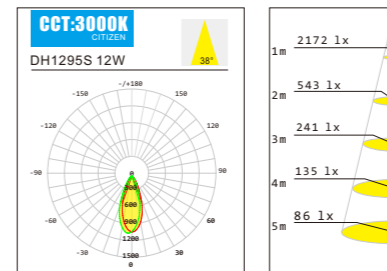
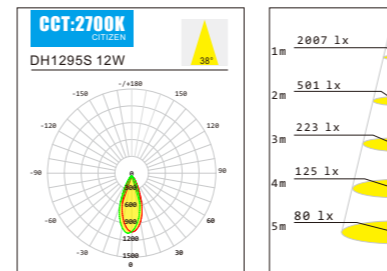
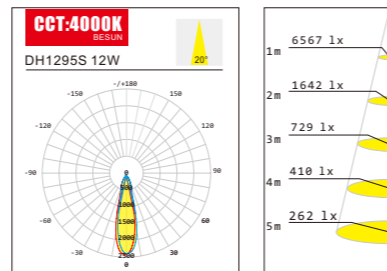
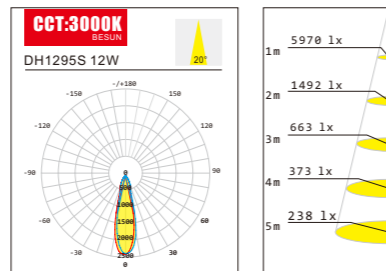
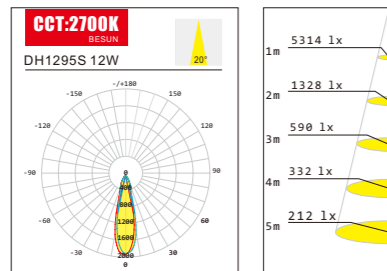

CCT/Parameters	BESUN DH1295S				BESUN DH1295E				CREE DH1295S		CITIZEN DH1295S		
2700K	Angle(°)	19.9°	39.9°	63.7°	94.2°	19.3°	39.5°	63.2°	94°	15.5°	37.4°	15.6°	38.1°
	RA	>90	>90	>90	>90	>90	>90	>90	>90	>80	>80	>90	>90
	LM	974	960	911	811	942	930	890	776	1166	1150	974	963
	UGR	14	17.1	25.4	28.3	13.9	17	25.1	27.9	11.8	16.1	12.7	16.3
3000K	Angle(°)	19.7°	39.7°	63.4°	94.1°	19.3°	39.4°	63.2°	94.1°	15.4°	37.3°	15.8°	38.2°
	RA	>90	>90	>90	>90	>90	>90	>90	>90	>80	>80	>90	>90
	LM	1088	1080	1016	906	977	960	920	805	1246	1231	1056	1040
	UGR	13.9	16.9	25.4	28.1	13.7	16.8	25.2	28.6	12.3	16.2	12.1	16
4000K	Angle(°)	19.9°	39.8°	63.6°	94.4°	19.4°	39.6°	63.7°	94.3°	15.5°	37.6°	16.3°	38.4°
	RA	>90	>90	>90	>90	>90	>90	>90	>90	>80	>80	>90	>90
	LM	1209	1179	1120	984	1077	1089	1034	896	1200	1201	1267	1244
	UGR	13.8	17.1	25	28.5	13.9	17.2	25.3	28.3	12.1	16.1	12.3	16.1
5000K	Angle(°)	20.1°	39.9°	63.9°	94.4°	19.8°	39.8°	63.7°	94.3°	-	-	-	-
	RA	>90	>90	>90	>90	>90	>90	>90	>90	-	-	-	-
	LM	1191	1171	1118	984	1097	1077	1034	900	-	-	-	-
	UGR	14	17	25.3	28.5	14.2	17.2	25.3	28.4	-	-	-	-
6000K	Angle(°)	20°	40°	64°	94.3°	19.7°	39.9°	63.8°	94.4°	-	-	-	-
	RA	>90	>90	>90	>90	>90	>90	>90	>90	-	-	-	-
	LM	1178	1158	1097	967	1030	1019	973	849	-	-	-	-
	UGR	14.3	17.1	25.5	28.3	14	17.3	25.5	28.7	-	-	-	-

Triac dimmer compatibility

Brand	Item No.	picture
CLIPSAL	32E450UDM 220-240VAC 50Hz MAX:450W	
CLIPSAL	32E450ULM 220-240VAC 50Hz MAX:450W	
JUNG	225NV DE 220-240VAC 50Hz MAX:20-500W	
GIRA	226200/I01 220-240VAC 50Hz MAX:20-500W	
BERKER	2873 220-240VAC 50Hz MAX:20-500W	

2000K-3000K dimmable downlight graph(LED)

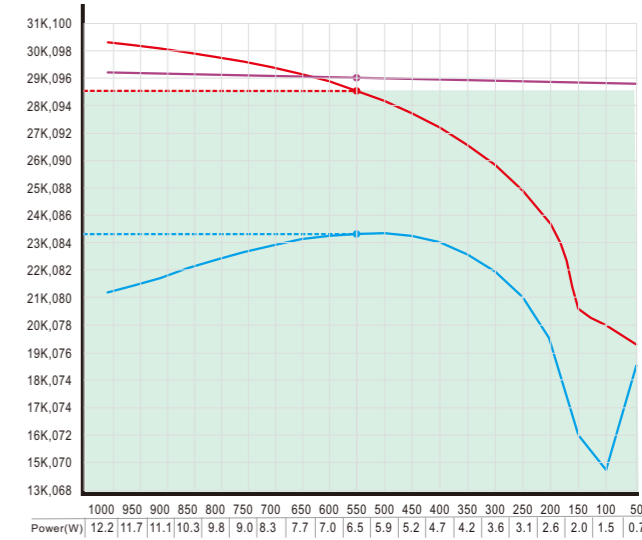

— CRI — CCT — light efficiency — DH1295S CCT dim range
 31K, 100=3100K, CRI 100 and 100LM/W
 1000=1000LM 950=950LM 900=900LM.....